

Fota Business Park Business & Office Units



fota
RETAIL &
BUSINESS
PARK

CARRIGTWOHILL
CORK • IRELAND



- Part of the Fota Retail and Business Park, which is one of the largest and architecturally most advanced Retail Warehouse and Commercial Developments in the Munster area
- Prestigious Business Campus environment
- High profile location with superb access from N25 dual carriageway
- Adjoining proposed Carrigtwohill commuter railway station
- Suitable for a wide variety of Business, Office and Technology Uses
- Units ranging in size from 120 sq.m. to 2177 sq.m.
- Landscaped Business Park with excellent car parking facilities



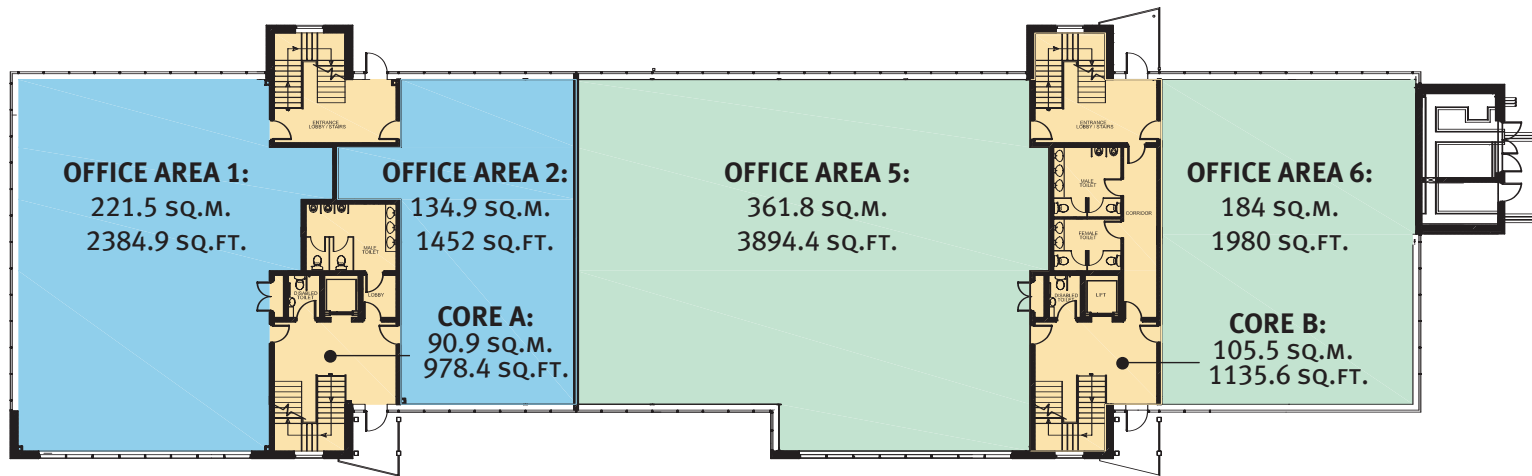

GROUND FLOOR PLAN

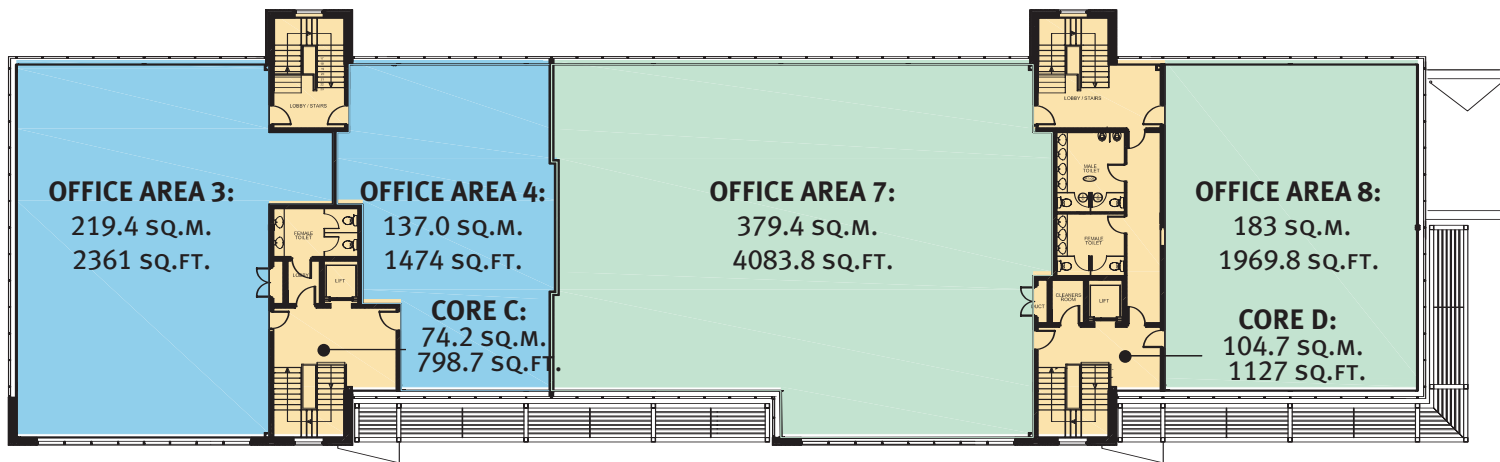

FIRST FLOOR PLAN



Business Park Specifications Business & Office Units

High Spec third generation office units

- Feature entrance and foyers, fully fitted to a high standard
- Excellent car parking facilities
- Suspended acoustic tile ceiling
- Fully air-conditioned
- Paint finish to all walls

JOINT AGENTS



1 South Mall, Cork
 Tel: 021 4275079
 Fax: 021 4272405
 Contacts:
 Margaret Kelleher (mkelleher@lisney.com)
 Edward Hanafin (ehanafin@lisney.com)



23 Marlboro Street, Cork
 Tel: 021 4277745
 Fax: 021 4272346
 Contact:
 Gerard O'Callaghan (gocallaghan@remax.net)

